

User's Manual

For Thermal Transfer Barcode Printer
GP-1124T/1125T GP-1134T/1135T GP-1125Z/1135Z

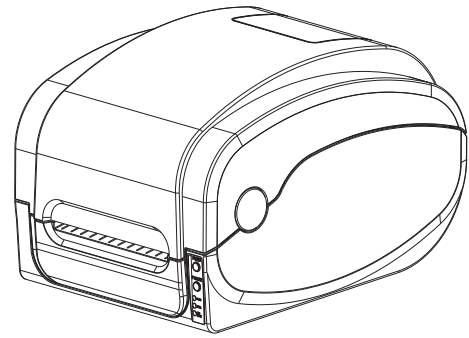

Please read this user guide before printer operation and keep this guide for reference.

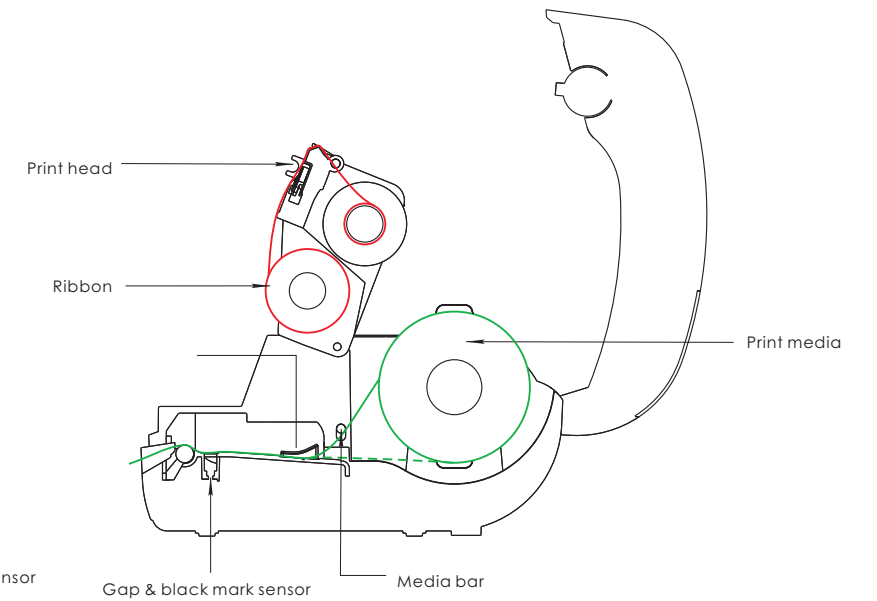
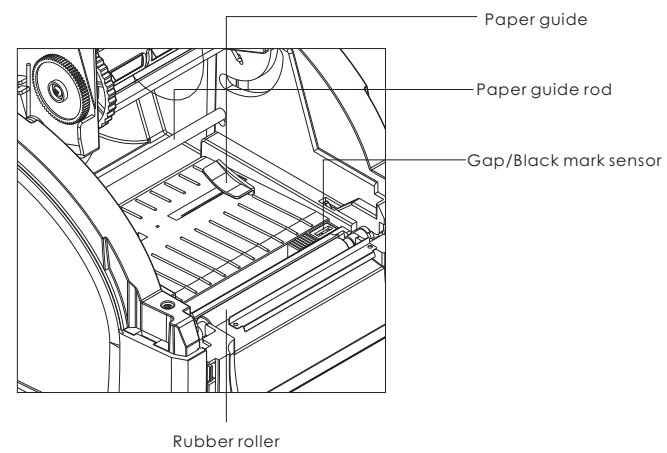
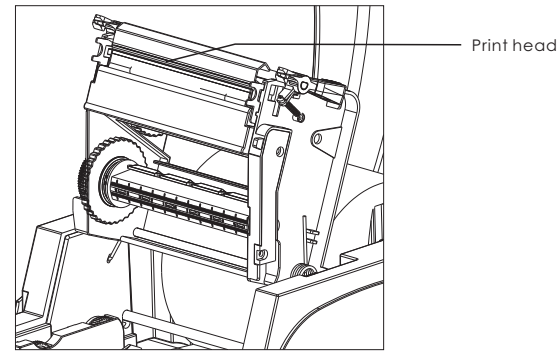
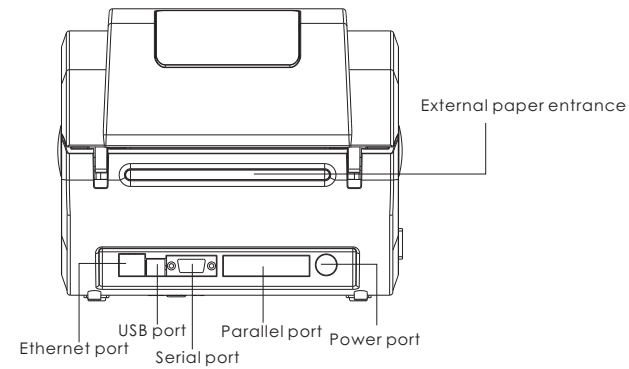
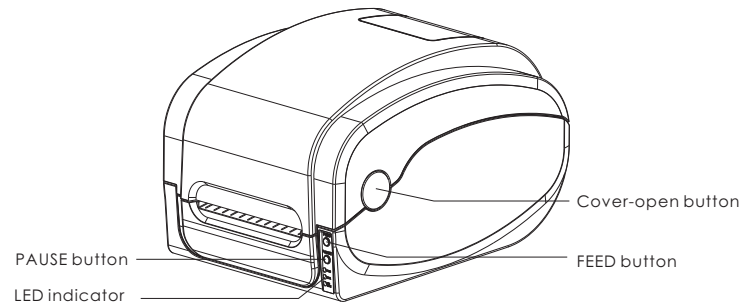

— Media path (Outside wound)
- - - Media path (inside wound)

*If you need more information about the product, please refer to the User's Manual in CD.
*The printer specification, accessory, spare parts and program are subject to change without prior notice.

Remark:
GP-1124T/1134T series comes with Serial+USB+Parallel port, with paper roll and ribbon, without external holder.
GP-1125T/1135T series comes with Serial+USB+Ethernet+Parallel port, with paper roll and ribbon, with external holder.

Note: The interface of printer showed in picture may have some difference from the model your purchased. As for the actual interface, please refer to the product specifications

Print media loading

1. Press two buttons on printer two sides to lift and open the cover.	2. Insert the print media into the shaft as picture showing, and fix the label roll in the middle.
3. Load print media into the printer; adjust the paper guide to be same width of print media.	4. Press the button to open print head mechanism.

5. Pull out the print media till it pass gap sensor and then close printer head mechanism to complete media loading.

Ribbon loading

1. Insert ribbon dispenser into an empty roll.	2. Install ribbon dispenser and roll into the printer, left side first, right side afterwards.

3. Insert ribbon dispenser into new ribbon	4. Open printer head by pressing the picture showing button	5. Install ribbon supply shaft into the printer, left side first, right side afterwards
6. Put our ribbon and let it touch the print head and the step 1 showing empty roll	7. Adjust the running wheel to let the ribbon touch print head in flat and smooth way	8. Close the printer head by pressing mechanism two side to make sure print head is closed completely for good printing quality

1.Introduction

Thanks for choosing GP-1124T/1125T/1134T/1135T/ direct thermal transfer label printer.

This series printer is built with 2sets of gear to drive motor,with capability of handling 300meters long ribbon and large label roll.Printer inner volume is fit for 5" OD(Outer Diameter)paper roll,if using external paper holder,you can install 8.4"OD industrial grade label roll.

This printer is designed for real-time and batch label printing,with standard serial, parallel,USB and Ethernet connection port. Direct thermal printing and thermal transfer printing modes are all in one printer body,so you can choose various kinds of printing materials,for example:thermal paper,plain paper,coated paper,silver paper, plastic paper etc.

Common 1D barcode and 2D barcode fonts are built inside printer,also it support 4 direction printing,characters can be enlarged from 1 to 10 times .Besides,it supports 5 different size bitmap fonts,OCR-A and OCR-B fonts,together with 203dpi higher print resolution,this series printer are your best choice among the same class.

Please refer to the information of software when printing label. If you need to write command by yourself, please also read program manual in CD or download it from our website. (www.gprinter.hk/www.gprinter.es).

● Application Field

Manufacturing & Warehousing logistic industry	Healthcare	Office & Studio
Product labeling and marking	Patients marking	
Warehouse management label	Medicine marking	
Category marking label	Specimen marking	Retail
Operation instruction marking label		Price Label marking
Distributing instruction marking label	Parcel Post	Product item marking
	Mailing label	Jewelry product marking

2.LED Indicator and Function

Direct Thermal Printing

LED Indicator status	Descriptions
Power indicator is on, Error indicator is off.	Printer is powered on and in normal printing status
Power indicator flashes every 640ms, Error indicator is off.	Printer is paused
Power indicator is off,Error indicator goes for 80ms,then goes off for 160ms,printer start beeping.	Printer cover is opened
Power indicator is off,Error indicator goes on for 500ms,then goes off for 6s.	Label gap detection error
Power indicator is off, Error indicator flashes every 160ms,after two times flashing, Error indicator goes off for 320ms,printer start beeping.	Paper out
Power indicator is off,Error indicator flashes every 160ms,after three times flashing,Error indicator goes off for 320ms, printer start beeping.	Black mark detection error
Error indicator flashes every 160ms.	Printer overheated protection mode is activated. After 1minute,the printer CPU will check print head temperature again. When temperature return normal, printer will work normally.

Thermal transfer printing

Ribbon indicator and power & error indicator work independently, below status can be existed with above status.

LED Indicator status	Descriptions
Ribbon indicator is on.	Ribbon is installed successfully
Ribbon indicator flashes every 300ms, beeper sounds every 2.4s	Ribbon improperly installed: no ribbon, or ribbon end, or ribbon broken

NOTE: Beeper function can be enabled through setting DIP swith.

3.Button Function

Feed

When the printer is ready(LED blue fixed),click the button,label paper into the front end of a paper label.

Pause

The printer in the print, click the PAUSE button to print suspended. At this time power indicator is blue flashing. Just click the button, the print job resume normal.

Power-on function

The printer has six kinds of power on functions can be used to set or test the printer hardware.In the boot and press the button with lamp signal release key can start these functions.

Six Power-on Functions:

Function	Descriptions
Self-test page	A.Turn off the printer. B.Make sure the paper roll is installed correctly and the printer top cover is closed. C.Press and hold FEED button and turn on the printer. Selftest page will be printed, then release FEED button. (You can use this functions to check if printing function is normal or not)
DIP Switch page	A.Turn off the printer. B.Make sure the paper roll is installed correctly and the printer top cover is closed. C.Press and hold PAUSE button and turn on the printer. When paper feed and then release FEED button,DIP switch page will be printed out.
Debugging Mode	A.Turn off the printer. B.Make sure the paper roll is installed correctly and the printer top cover is closed. C.Press and hold PAUSE and FEED button and turn on the printer.When Power indicator(blue) and Error indicator (red) are on at the same time,release PAUSE and FEED button,printer goes to Debugging Mode. 

Skip AUTO.BAS program	User can use TSPL2 command to save a code auto running file(AUTO.BAS) into flash. When turn on printer, printer will run the program automatically. If you want to skip AUTO.BAS program onpower-up then follow below steps. A.Turn off the printer B.Press and hold PAUSE and FEED button and turn on the printer. When power indicator (blue) is off and the error indicator(red) is on, release PAUSE and FEED button, printer will skip running AUTO .BAS program, and them power indicator will be on.
Printer Initialization	A.Turn off the printer. B.Press and hold PAUSE and FEED button and turn on the printer. When power indicator (blue) is on and the error indicator(red) is off, release PAUSE and FEED button, all data in printer DRAM will be cleared and the printer setting will be restored to factory default setting.
Ribbon Detection	When printer power turn on,or it is in thermal transfer printing mode,printer will automatically detect ribbon status,to check if ribbon installed,or ribbon end,or work normally.

Note: You're suggested to use up to 80mm wide paper for full printer information printing when relating with above power-on functions.

Storage space is exceeded (FLASH/ DRAM)	FLASH/ DRAM Storage is exceeded	Clear unnecessary file from FLASH/ DRAM. DRAM only can save 256 files. Max capacity:1024KB. FLASH only can save 256 files. Max capacity:1024KB.
Not good printing quality	Ribbon and label improperly installed. Too much dust or adhesive on print head. Print density setting wrong. Print head damaged. Ribbon and label not match.	Re-install ribbon and/or label. Clean print head and print and print again. Clean Rubber roller. Adjust print density and speed. Take selftest page to check if printing are completely to confirm if necessary to change new print head. Change suitable ribbon and label paper. If the label thickness exceed 0.22 mm or it will affect the printing quality. Check if the print head base is totally closed.
When printing paper out of step	Label paper size wrong setting. Label sensor was covered	Adjust label size and print again. Reduce the gap value and print again. Clear the sensor.
Data miss printing in one or two sides	Label paper size wrong setting. Exceed the max printing width.	Adjust label size and print again. Change roller with maximum width
Ribbon wrinkle	Print head unbalanced stress; Ribbon & label improperly installed; Label feeding not smoothly; Print density setting incorrectly.	Reset the label print density. Adjust paper width fixing stand to fit your label paper size. Adjust the DIP Switch to enlarge the scrolling speed of ribbon.
Grey line appeared in Black label	Dirty on print head. Dirty on rubber roller.	Clean print head. Clean rubber roller
Printing not stable	Printer in HEX Dump mode RS-232 setting wrong	Restart your printer and leave Dump Mode. Reset the printer consistent with computer baud rate.

4.DIP SWITCH FUNCTION

DIP NO.	Function	ON	OFF
1	Beeper	Disabled	* Enabled
2	Reserved	-----	-----
3	Ribbon detect	Disabled	* Enabled
4	Sensor	* High sensitivity	Normal Sensitivity
5	Power on paper feed	Disabled	* Enabled
6	Reserved	* Enabled	Disabled
7&8	Baud rate set	-----	* Default value

BAUD RATE :

7	8	BAUD RATE
OFF	OFF	9600 *
OFF	ON	19200
ON	OFF	38400
ON	ON	115200

*is default value.



5.Troubleshooting

Below the table of contents are generally common problems and solutions, you can also contact your local service provider for more technical support.

Problems	Possible Reasons	Solution and Suggestion
Power indicator not "ON"	Plug to AC outlet and plug to printer not well connected.	Check power connector and AC outlet if plugs are correctly connected.
	Printer power not turned on	Turn on power switch
	Print head not well closed	Close print head by pressing whole print head mechanism
	Ribbon end	Change new ribbon.
	Ribbon improperly installed	Refer to Ribbon loading steps in User Manual to re-install ribbon
	Label paper end	Change new label paper
	Label paper improperly installed	Refer to Print media loading steps in User Manual to re-install paper.
Label paper jamed	Gap sensor detection error	A d j u s t paper specification and print again
	Label paper jamed	Clear jamed paper
		Reconnect the cable If connecting with Serial cable : : 1.Change a new cable Check if Pin configuration in cable two sides are matching each other; 2. Check if baud rate setting on PC and printer are the same. If connecting with Ethernet

Not printing	1.cable improperly connected	cable 1. Check if RJ-45 green/orange LED indicator is on. 2.When printer receive and process printing data,LED will be orange color; 3.Check if printer IP is assigned in DHCP mode 4.Check if fixed IP address is correctly set in printer property. 5.Wait for some minutes to make sure printer is connected server and printing a selftest page to confirm printer IP address.
	2.Pin configuration in cable two sides are not matching each other	If connecting with USB cable 1.Check if choose USB virtual port in driver of computer. Please try and print if many virtual ports are existed. 2.Change new cable.
	Ribbon non standard	Check the ribbon model and specification Check and re-install ribbon to make sure printing side touch label paper.
	Ribbon printing side wrong installed	Clean print head and print again. Suggest density set to be 7
	Print head not clean	density setting wrong. Re-connect print head
	Print density setting wrong	Re-connect motor cable
	Print head cable not well connected	Check if there is PRINT command at the end of printing file; or if there is
	Motor cable not well connected	
	Command setting wrong	